

TECHNICAL GUIDE

Liquid level indicators

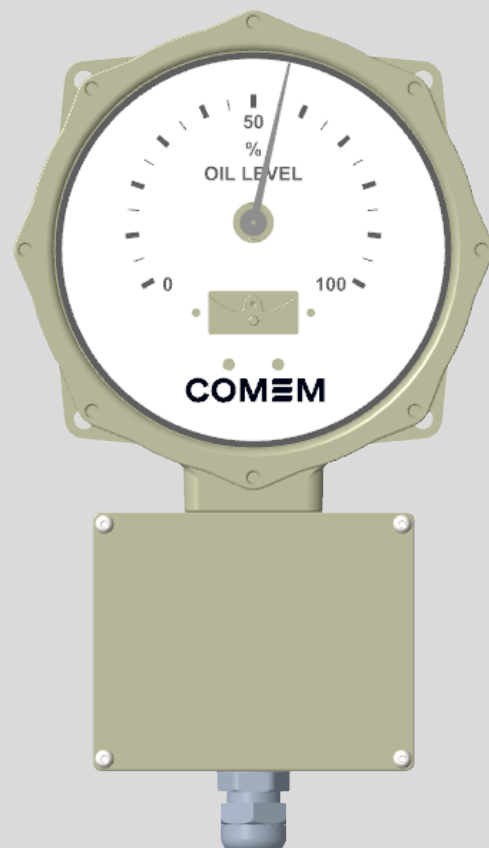
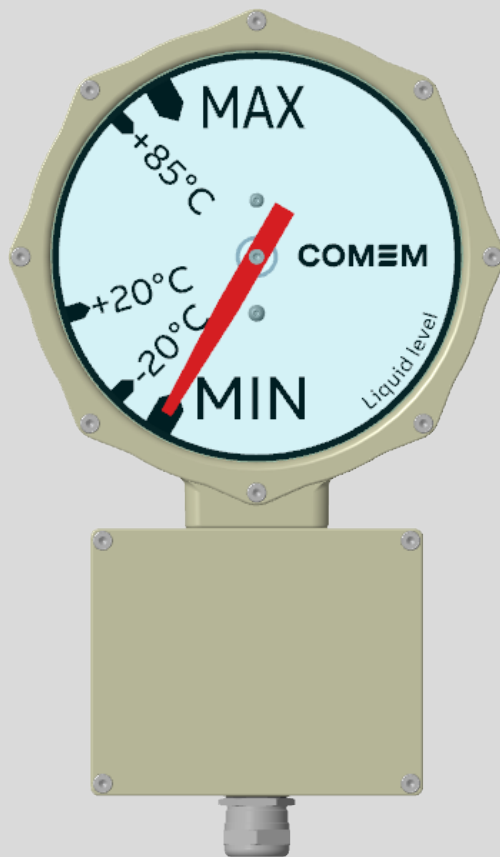

Content index

Application	4
Technical data	5
Floating elements Dimensions	7
Electrical scheme	15
Version with Plug-in connector	16
Order sheet	17

Application

Standard features														Options					
Type	Dial diameter (mm)	Holes x Ø (mm)	Wheelbase (mm)	Weight (kg)	Fixed contacts (up to 4)	Indication: Pointer	Indication: Circular dial (red/white)	Angle design	Radial movement	Axial movement	Suitable for conservator with rubber bag	Removable body from the fixing flange	Corrosion protection: C4 Medium. Moderate salinity (ISO 12944)	4-20 mA oil level monitoring MODBUS RTU communication	Adjustable contact (up to 4)	Corrosion protection: C5 Medium Coastal area (ISO 12944)	Corrosion protection: CX Off shore (ISO 12944)	Solution with carter (Fig. 4)	Remote visual indicator (eViewer)
OLI	146	4 x Ø 13	102	3.3	●	●	-	●	●	●	●	●	●	-	●	●	●	-	-
eOLI	146	4 x Ø 13	102	3.5	●	●	-	●	●	●	●	●	●	●	●	●	●	-	●
OLI22	146	8 x Ø 11.5	190	3.5	●	●	-	●	●	●	●	●	●	-	●	●	●	●	-
eOLI22	146	8 x Ø 11.5	190	3.7	●	●	-	●	●	●	●	●	●	●	●	●	●	●	●
L140	90	6 x Ø 7	125	1.4	●	●	●	-	●	●	●	-	●	-	-	●	-	-	-
L220	166	8 x Ø 11,5	190	2.3	●	-	●	-	●	●	●	-	●	-	-	●	-	●	-
L340	250	8 x Ø 18	305	6.0	●	-	●	-	●	●	●	-	●	-	-	●	-	-	-

Technical data

Liquid Level Indicators	Technical data
Material	
Housing and upper part inclusive terminal box	C4-Medium: Aluminum casting, RAL 7032 powder coated; C5-Medium: Coastal area on request (surface treatment, not painted) CX Off shore: on request (RAL 7035)
Lens material (dial protection)	Polycarbonate (standard), temperate glass (optional)
Float	Rohacell
Characteristics data	
Standard	IEC 60076-22-1
Installation	Indoors and outdoors, tropical proof
Ambient temperature	-40°C to 80°C / -40°F to 176°F (arctic version on demand)
Oil temperature	-40°C to 120°C / -40°F to 248°F
Degree of protection	IP66 in accordance with EN60529 (L340 and L220 available only IP65)
Protected micro switches	
Number and types	Up to 4 micro switches
Tolerance switches operation	±2.5°
Switching points	5° before the Min and Max
Nominal Voltage	24 – 230 VAC/DC
Making capacity	2A
Max breaking capacity DC	0.25 A at 250 VDC (L/R<40 ms)
Max breaking capacity AC	3 A at 250 VAC (cosΦ>0.5)
Rated insulation voltage	2.0 kV AC 1 min between contacts and earth, 1.0 kV AC 1 min between open contacts
Connection	
Connection terminals	Min 0.25 mm ² / max. 4 mm ²
Cable gland	M25 x 1.5 (n°1 for coventional version and n°3 for eDevices)
Mechanical test	
Sinusoidal (EN 60721-3-4)	cl.4M4: 2-9 Hz (6 mm peak to peak), 9 – 200 Hz (1 g) – All axis
Shock	cl.4M4: 10 g (11 ms) in all the directions (EN60721-3-4)
Seismic	EN60068-3-3 (cl.0, level II)

Technical data

Oil Level Indicator	Dial indication movement
Angle range	120° (axial or radial)

eDevices (Comem eOLI/eOLI22)	Technical data
Analog output	4-20 mA (dielectric strength between electronic card and analogical output: 2kV) Maximum resistance: 450 Ω Accuracy : 2.5% of full scale
Digital output	Serial RS485 for MODBUS RTU Accuracy : 2.5% of full scale
Rated voltage	24 VDC \pm 10% polarized - active current loop
Ventilation valve	To prevent the formation of condensation
Wires	Max 2.5mm ² – advised 4x1mm ² or 6x1mm ² shielded twisted pair cable for analog/digital output
EMC guaranteed	Cable length up to 30 m / 98 ft
Current consumption	Max. 0.5 W

Comem eViewer	
Analog input (eOLI or eOLI22)	4-20 mA
Rated voltage	24 VDC \pm 10% polarized
Ventilation valve	To prevent the formation of condensation
Wires	Max 2.5mm ² – advised 4x1mm ² or 6x1mm ² shielded twisted pair cable for analog/digital output
EMC guaranteed	Cable length up to 30 m / 98 ft
Current consumption	Max 0.5 W

Floating elements

Radial movement "LA" (Fig.1)

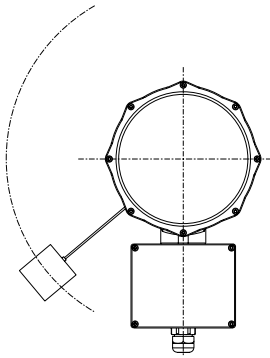

Axial movement "LB" (Fig.2)

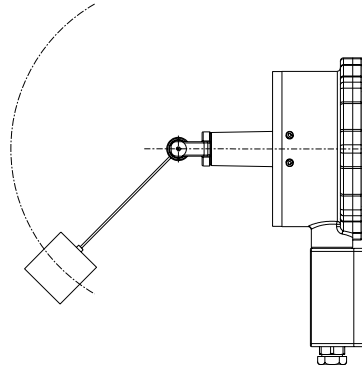

Axial movement with Bent arm "LB" (Fig.3)

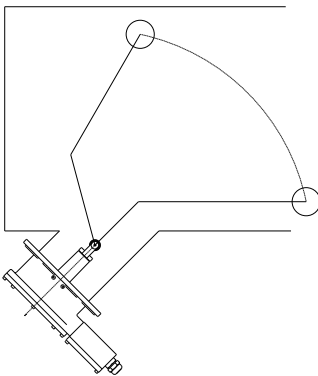

Axial movement for Carter design (Fig.4)

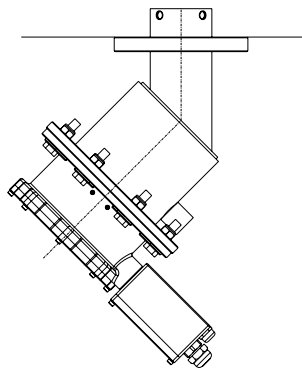

Radial movement for angle design (Fig.5)

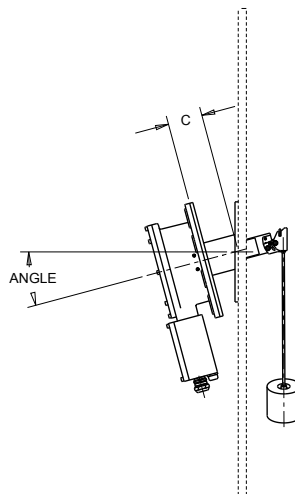
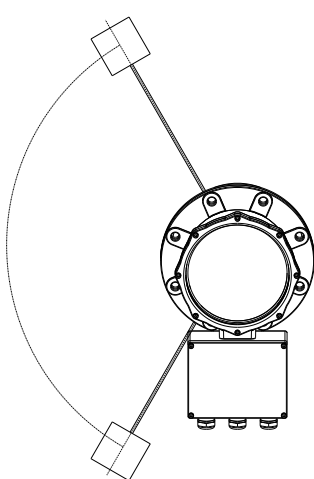

Case dimensions

OLI/OLI22/eOLI/eOLI22

OLI/OLI22

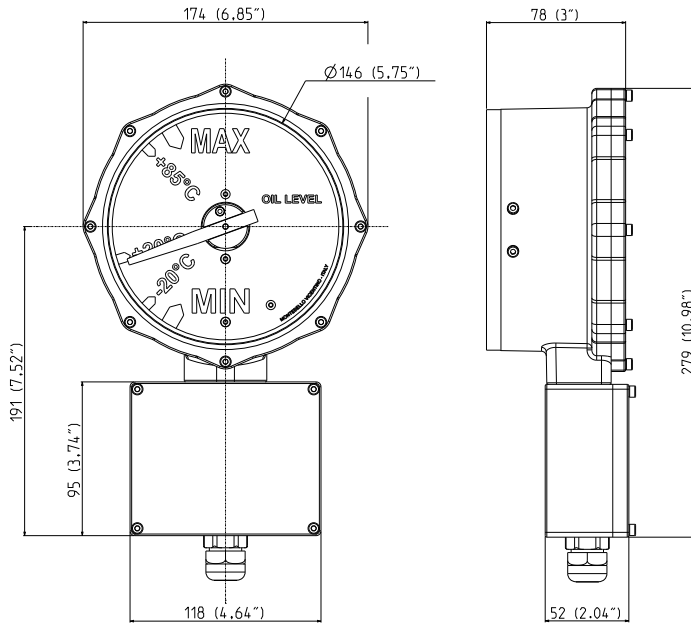

eOLI/eOLI22

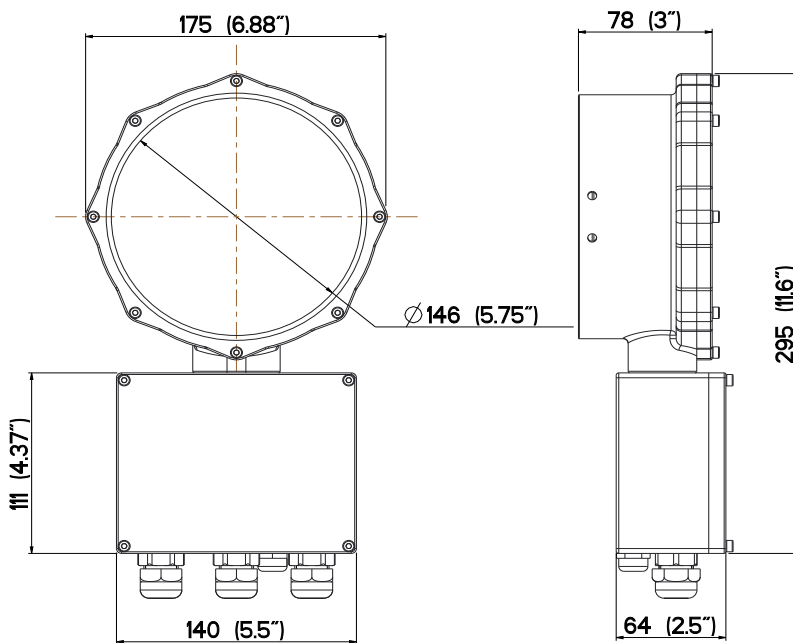

DIN Flange dimensions

OLI / eOLI Hole of the tank from 52 mm to 54 mm

Radial movement for OLI/eOLI

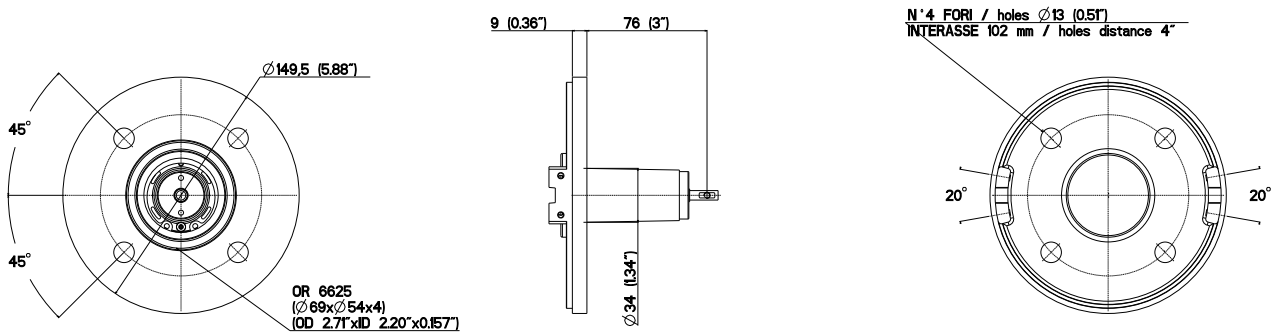

Axial movement for OLI/eOLI

Axial movement for OLI/eOLI

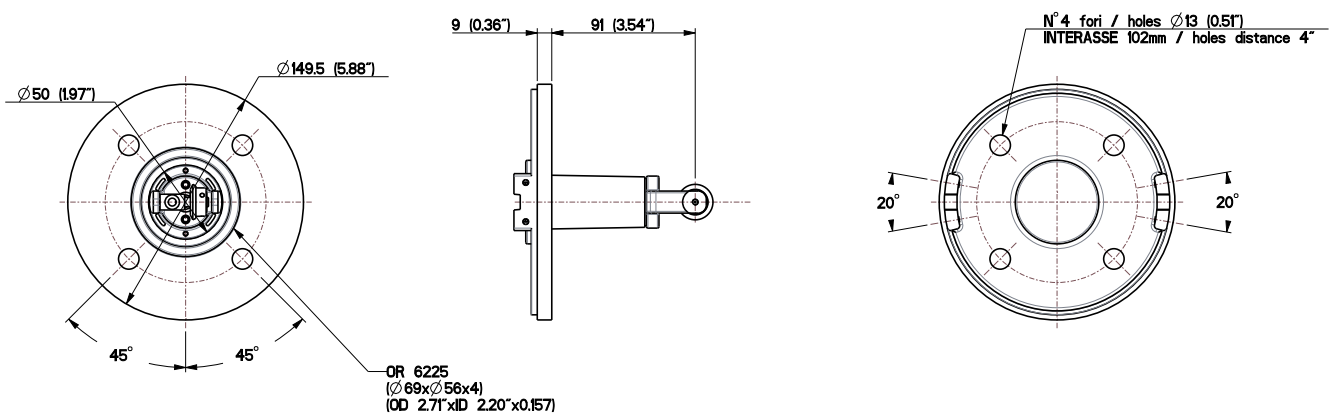

Flange dimensions

OLI22 / eOLI22 Hole of the tank from 70 mm to 140 mm

Radial movement for OLI22/eOLI22

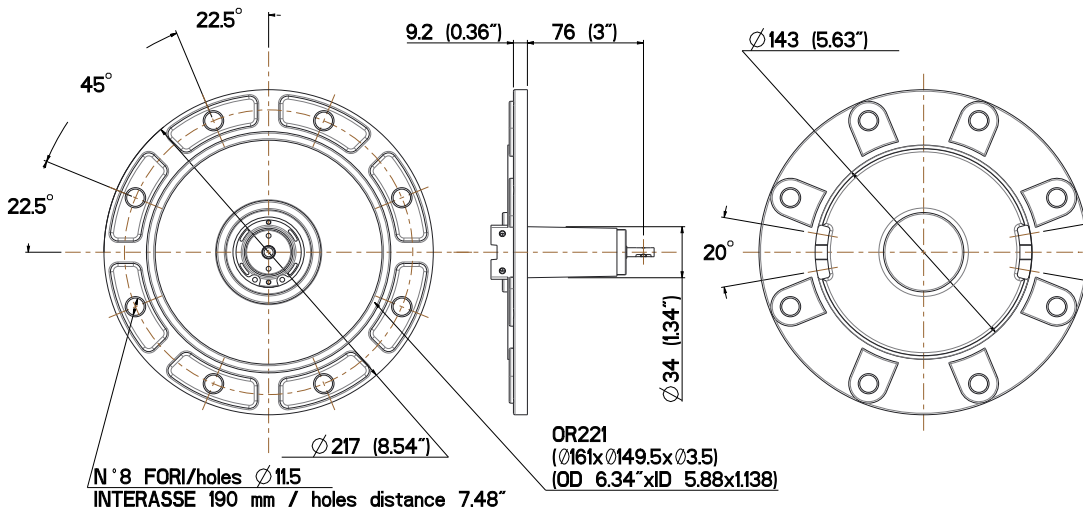

Axial movement for OLI22/eOLI22

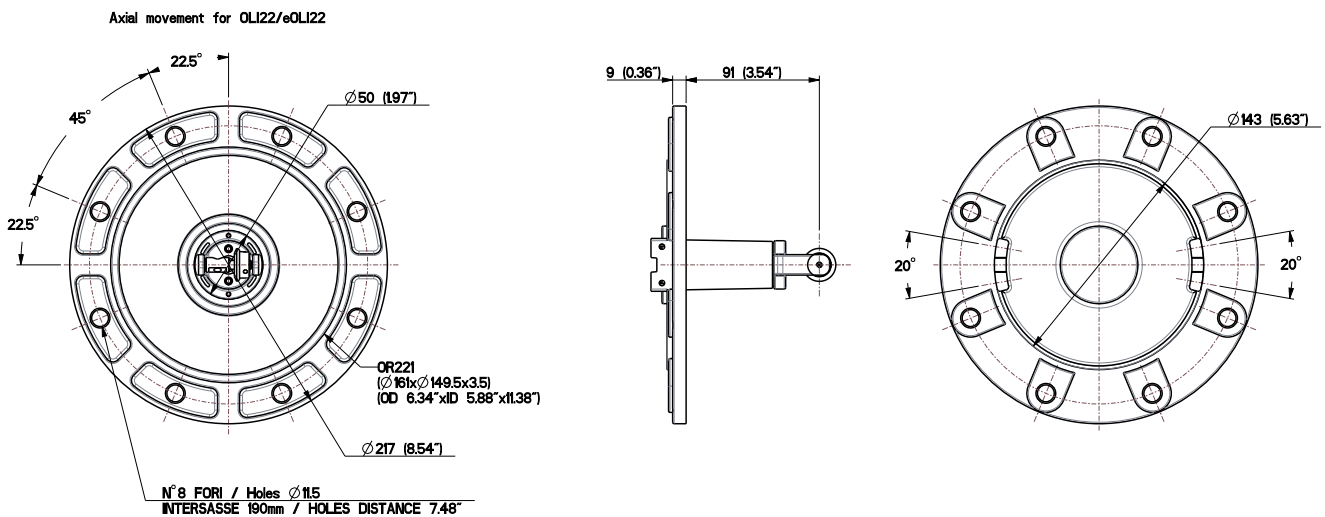

eViewer dimensions

eViewer

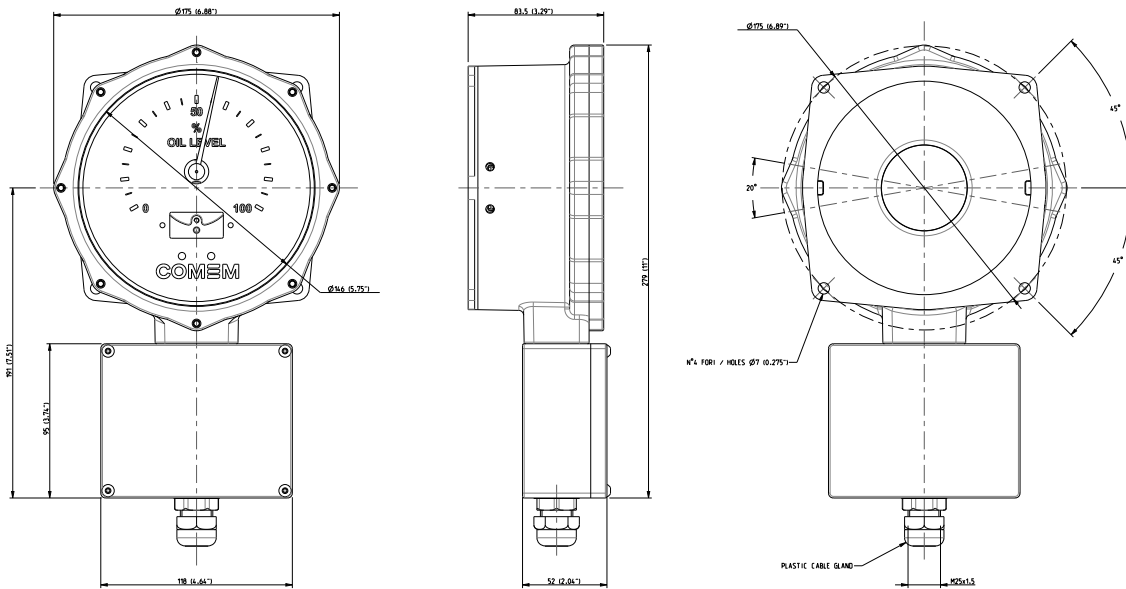

eOLI - eViewer connection

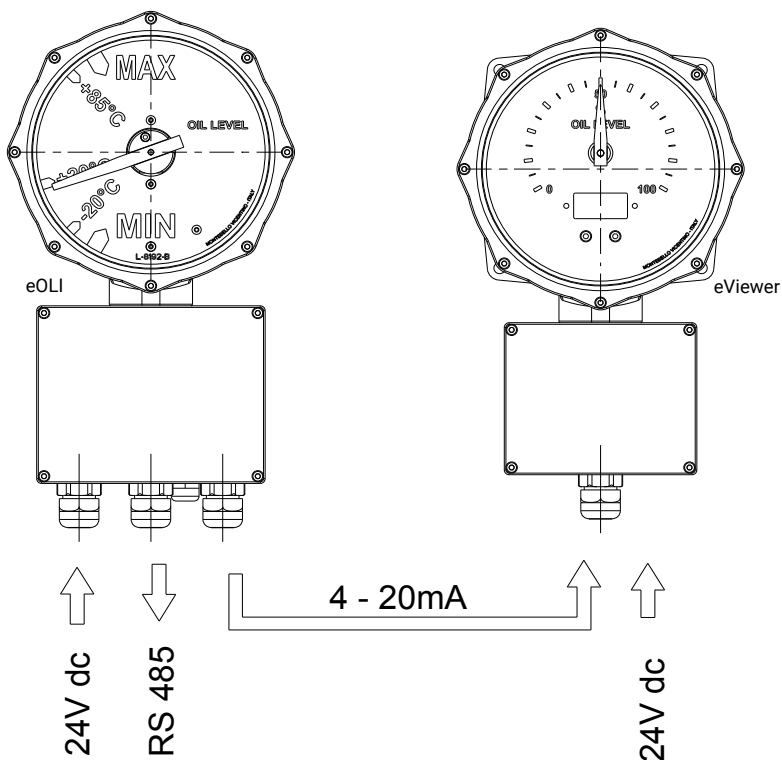

COMEM is an ISO 9001 system certified. Information subject to change without notice

L140 dimensions

Radial movement for L140
Hole of the tank from 70 mm to 84 mm

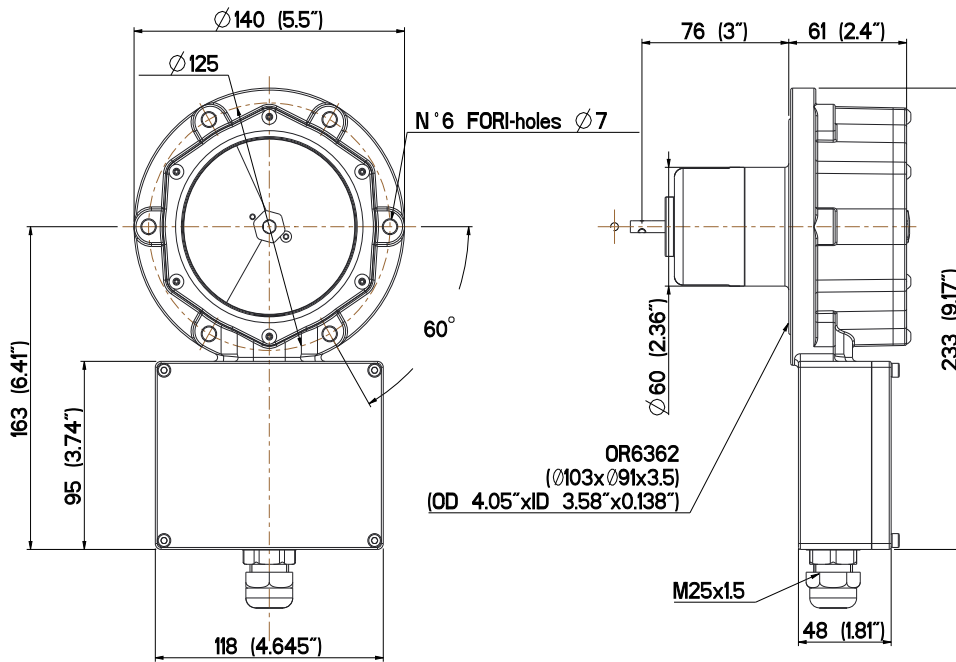

Axial movement for L140

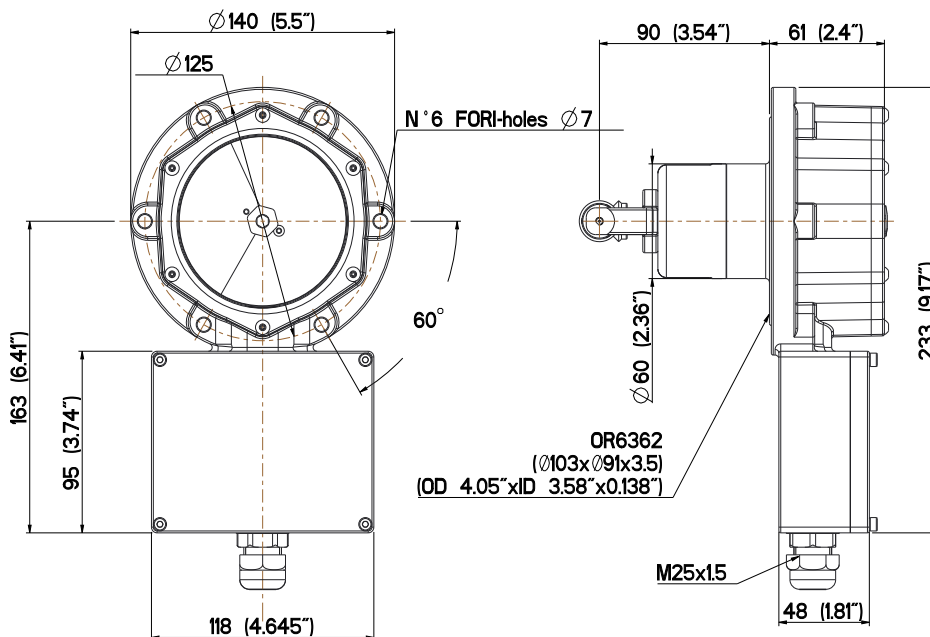

L220 dimensions

Radial movement for L220
Hole of the tank from 70 mm to 140 mm

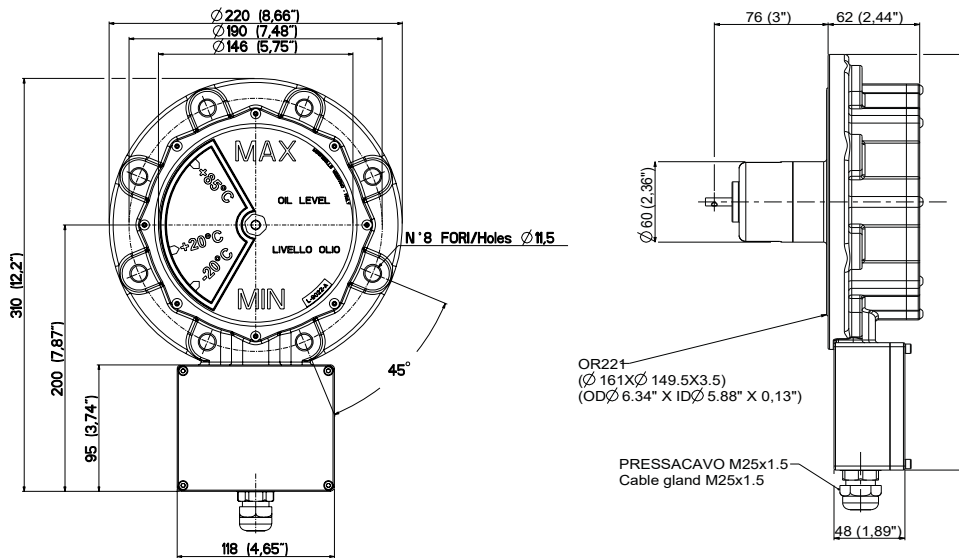

Axial movement for L220

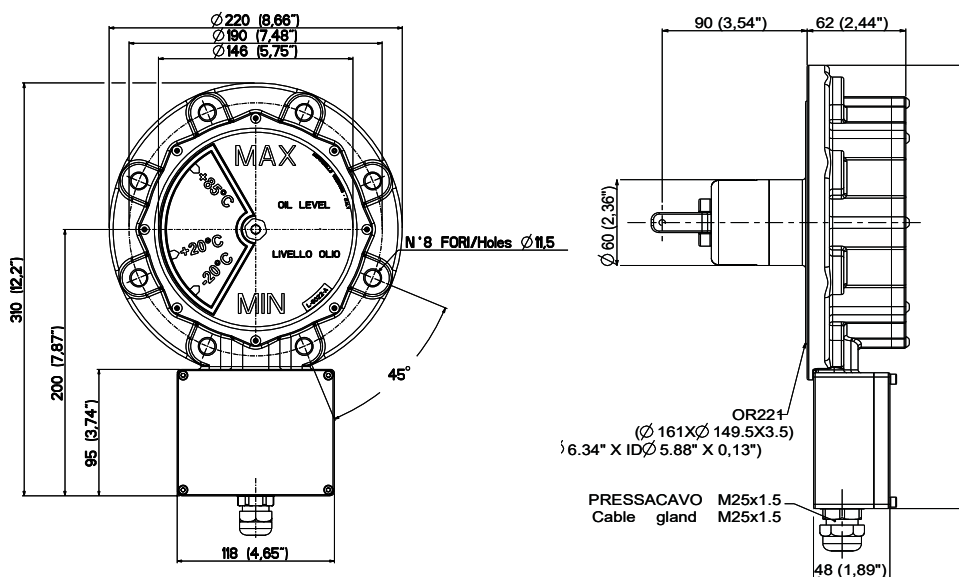

L340 dimensions

Radial movement for L340
 Hole of the tank from 70 mm to 230 mm

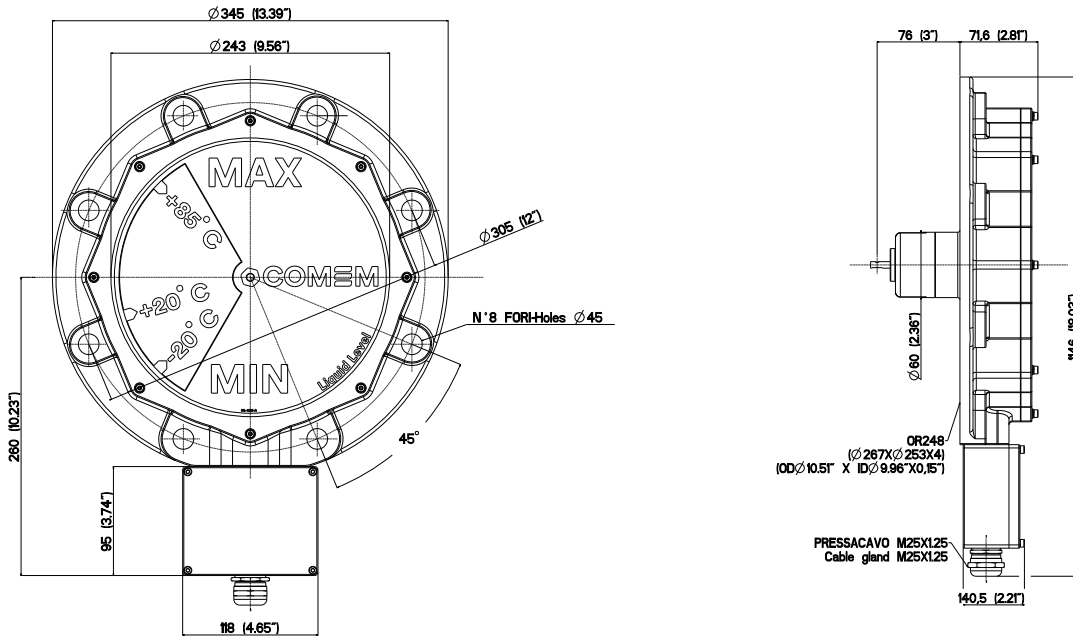

Axial movement for L340

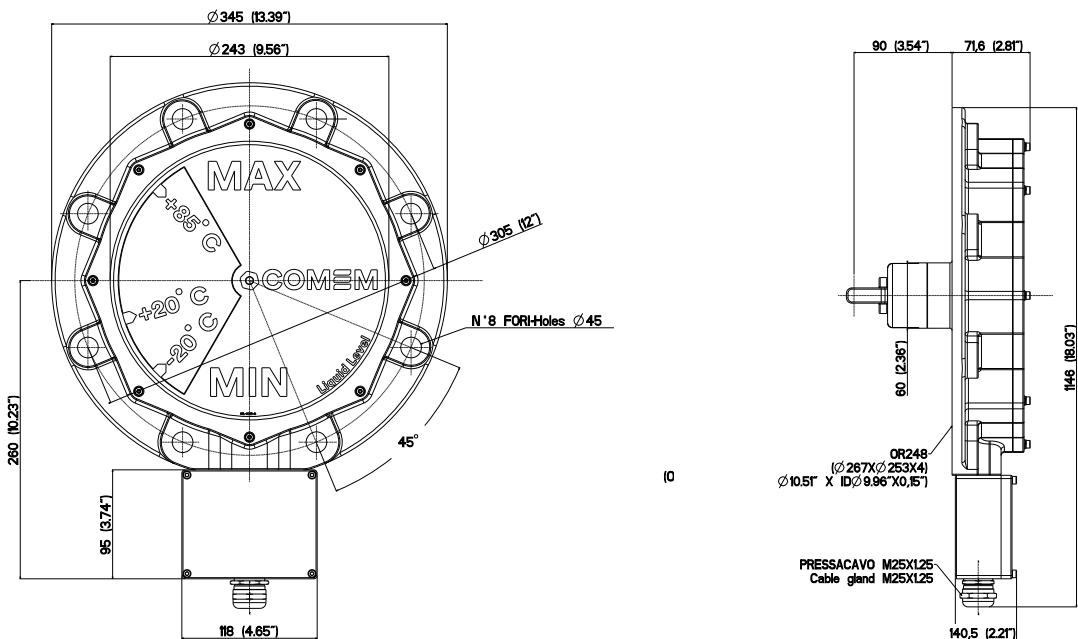

Electrical scheme

Micro switch types

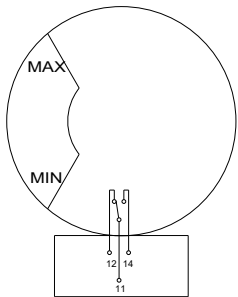

DIAGRAM K

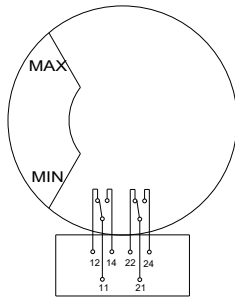

DIAGRAM Y

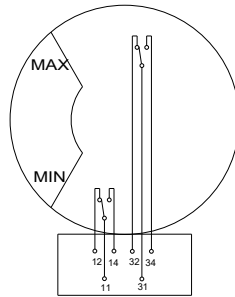

DIAGRAM X

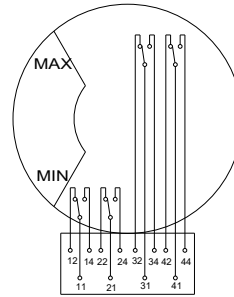

DIAGRAM W

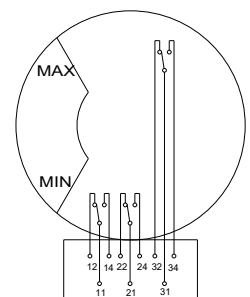
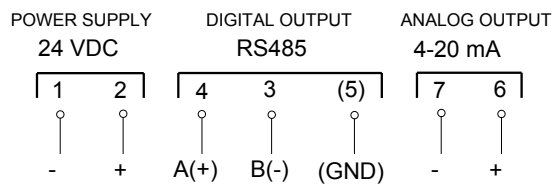
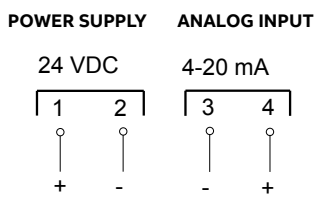

DIAGRAM N

eOLI / eOLI22



eViewer



Liquid level indicators with plug-in connector

Case dimensions for OLI/OLI22 with plug-in connector

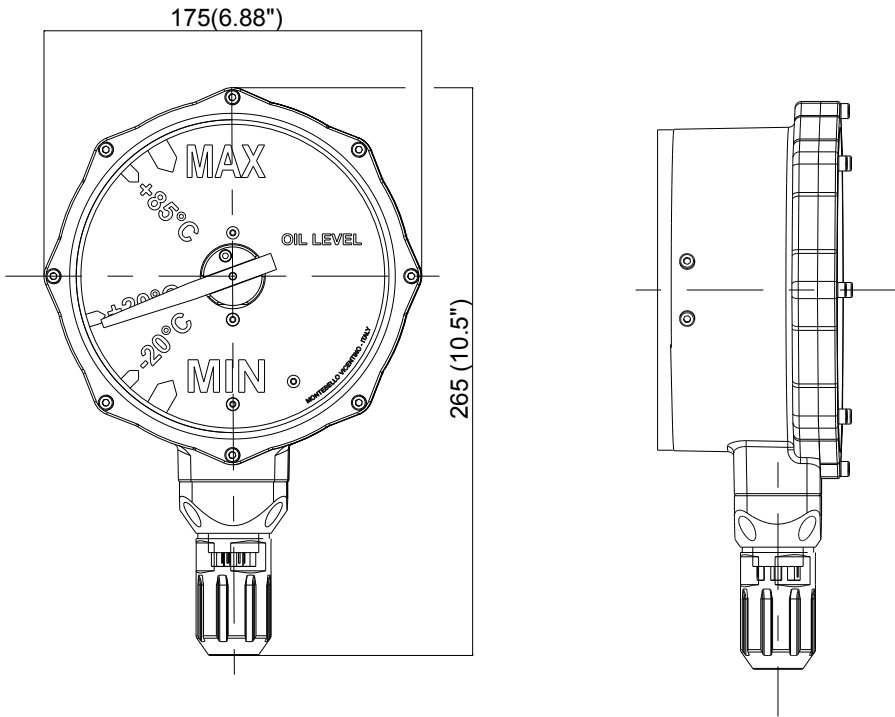

Electrical scheme for OLI/OLI22 with plug-in connector

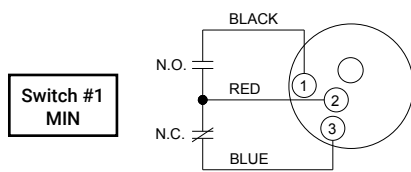

Scheme K

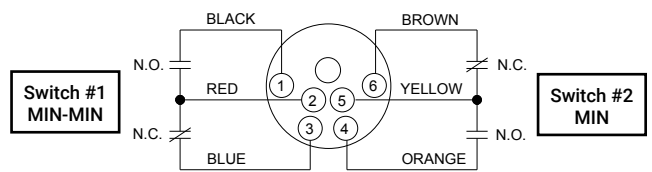

Scheme Y

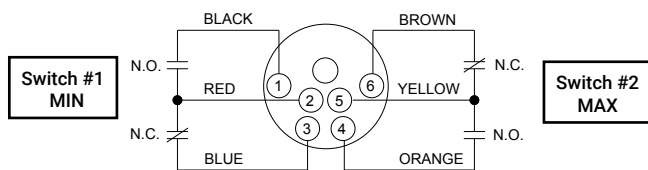

Scheme X

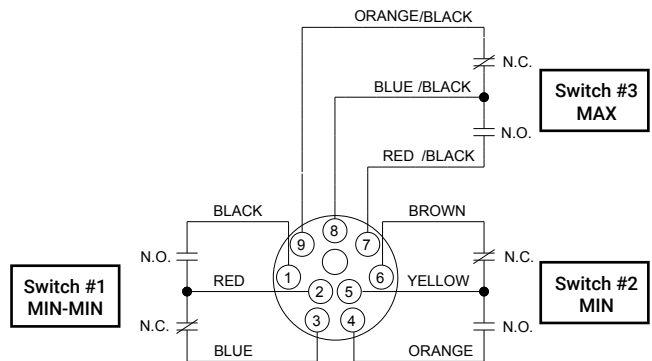

Scheme N

Order sheet

Type	See Fig. 6-7
L140	Pointer
L140	Circular Red/white
OLI	Pointer
eOLI	Pointer
OLI22	Pointer
eOLI22	Pointer
L220	Circular Red/white
L340	Circular Red/white
eViewer (for visualisation only)	Pointer

Date	
Rev.	
Customer reference	

Shaft movement	For complete details fill-in:
Radial movement (Fig.1 - Page 7)	page 19
Axial movement (Fig.2 - Page 7)	page 20
Axial movement with bent arm (Fig.3 - Page 7)	page 21
Axial movement for carter design - only OLI22 – eOLI22 – L220 (Fig.4 - Page 7)	page 22
Radial movement for angle design (Fig.5 - Page 7)	page 23

Type of switches
Fixed (standard)
Adjustable (only for OLI/OLI22 /eOLI/eOLI22)

Lens material (dial protection)
Polycarbonate (standard - not available for CX offshore corrosion protection class)
Glass (optional)

Electrical Scheme with terminal box (page. 15)	
1 min	K scheme
2 min	Y scheme
1 min + 1 max	X scheme
2 min + 1 max	N scheme
2 min + 2 max	W scheme

Gasket
NBR (from -40°C up to 120°C) Standard
Viton (from -10°C up to 150°C)
Fluorosilicone (from -60°C up to 200°C)

Electrical Scheme with plug-in connector only for Comem OLI/ OLI22 (page. 16)	
1 min	K scheme
2 min	Y scheme
1 min + 1 max	X scheme
2 min + 1 max	N scheme

Corrosion protection class
C4 Medium acc. to ISO 12944 (standard)
C5 Medium acc. to ISO 12944 (not paintable)
CX offshore acc. to ISO 12944 (RAL 7035) Only for OLI/OLI22/eOLI/eOLI22/eVIEWER



Fig.6: Circular Red/White



Fig.7: Pointer

Order sheet

Choose dial type

Date	
Rev.	
Customer reference	

Dial with standard marks

Mark	Oil conservator height Y* (mm)	Position and number of micro switches
Max		
+85°C		
+20°C		
-20°C		
Min		

For oil conservator height Y consult the following pages

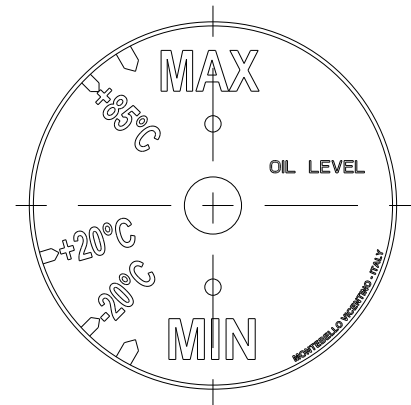

STANDARD MARKS

Or:

Dial with special marks

Mark	Marking on dial	Oil conservator height Y* (mm)	Position and number of micro switches
Max			
Mark 4			
Mark 3			
Mark 2			
Mark 1			
Min			

For oil conservator height Y consult the following pages

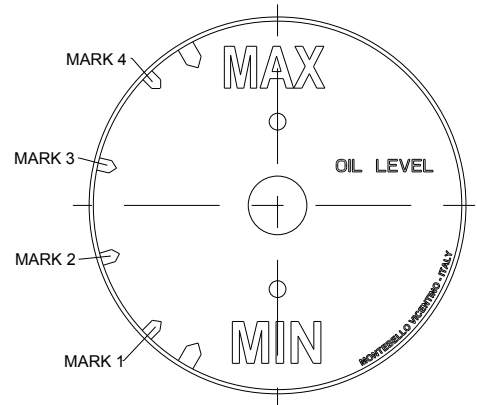

SPECIAL MARKS

Liquid level indicator with radial movement

Date	
Rev.	
Customer reference	

General features (mm)

Conservator diameter	Ø	
Displacement between the conservator and dial centers	S	
Length shaft inside the conservator	A	76 mm (standard)
		90 mm (special)

* Other dimensions are available upon request. Please indicate all the dimensions of the conservator and we will propose to you the most suitable configuration

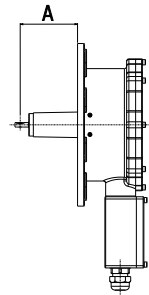
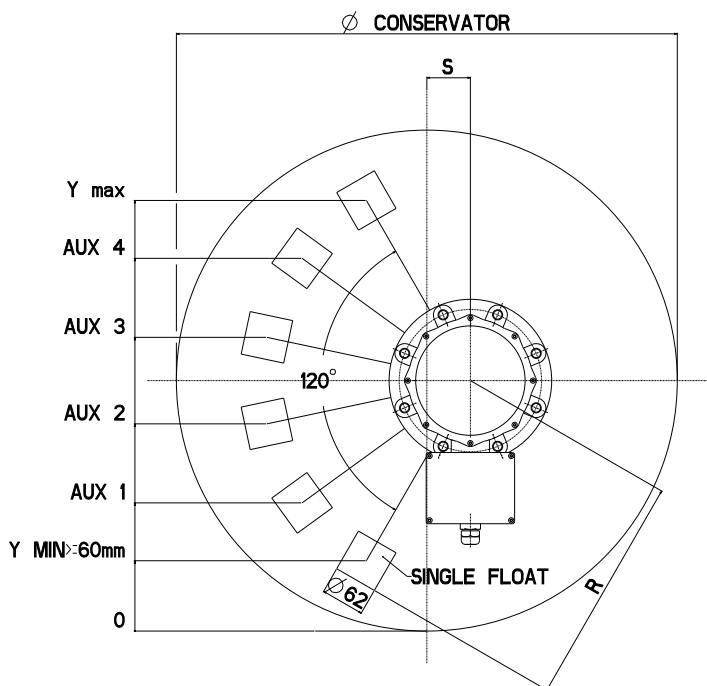

Length of the arm with float

Type	R: Standard (mm)	R: Special >=100mm
L140	370	
L220	550	
OLI	550	
OLI22	550	
L340	710	

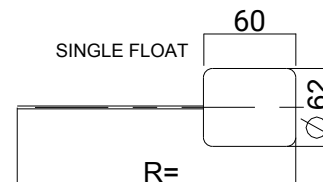

For further information or clarification, please contact our support team. E-mail address: customerservice@it.comem.com

COMEM is an ISO 9001 system certified. Information subject to change without notice

Order sheet

Liquid level indicator with axial movement (Fig.2 - page 7)

Date	
Rev.	
Customer reference	

General features (mm)

Conservator diameter	Ø	
Conservator length	M	
Oil Level Indicator inclination	Angle	0° (Standard)
		special:
Length inside the conservator	A	90 mm (Standard)
		110 mm (Special)
Displacement between flange and conservator	C	
Height from the conservator base	X	
Tube diameter	K	

* Other dimensions are available upon request. Please indicate all the dimensions of the conservator and we will propose to you the most suitable configuration

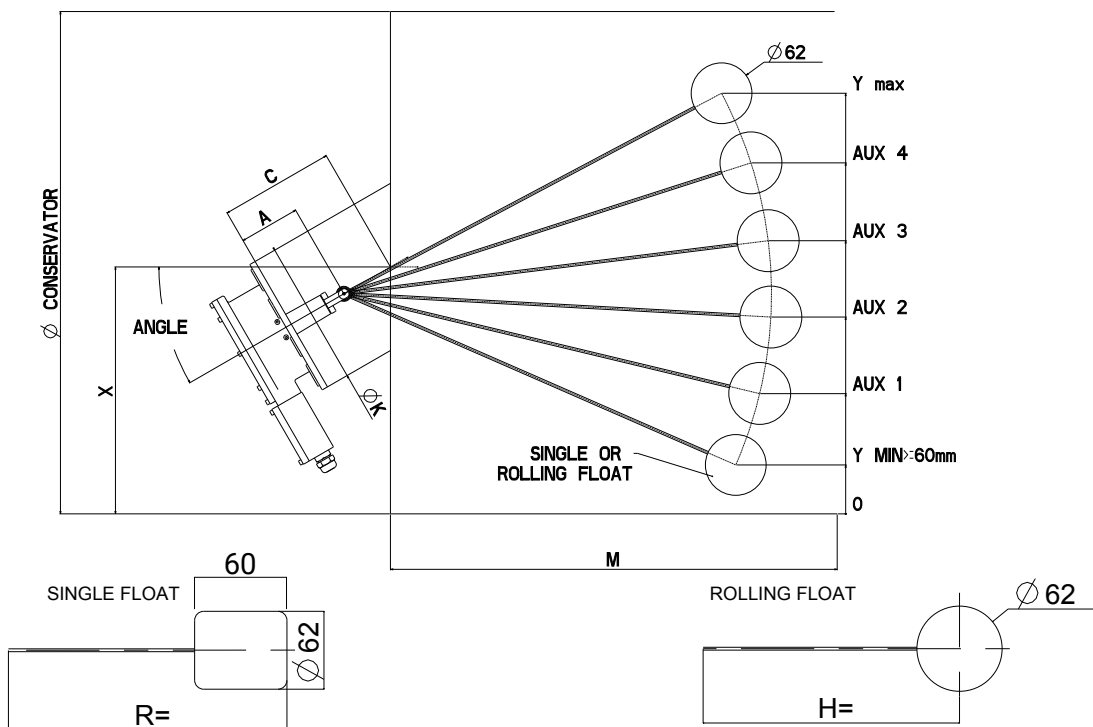

Length of the arm with single float

Type	R: Standard (mm)	R: Special >=130mm
L140	370	
L220	550	
OLI	550	
OLI22	550	
L340	710	

Length of the arm with rolling float

Type	H: Standard (mm)	H: Special >=110mm
L140	370	
L220	550	
OLI	550	
OLI22	550	
L340	710	

Liquid level indicator with bent arm with axial movement (Fig.3 - page 7)

Date	
Rev.	
Customer reference	

General features (mm)

Conservator diameter	Ø	
Conservator length	M	
Length inside the conservator*	A	90 mm (Standard)
		110 mm (Special)
Tube diameter	K	
Displacement between flange and conservator	C	

* Other dimensions are available upon request. Please indicate all the dimensions of the conservator and we will propose to you the most suitable configuration

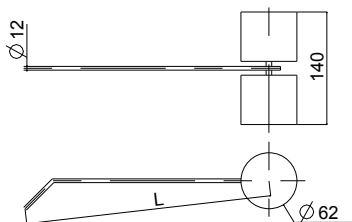
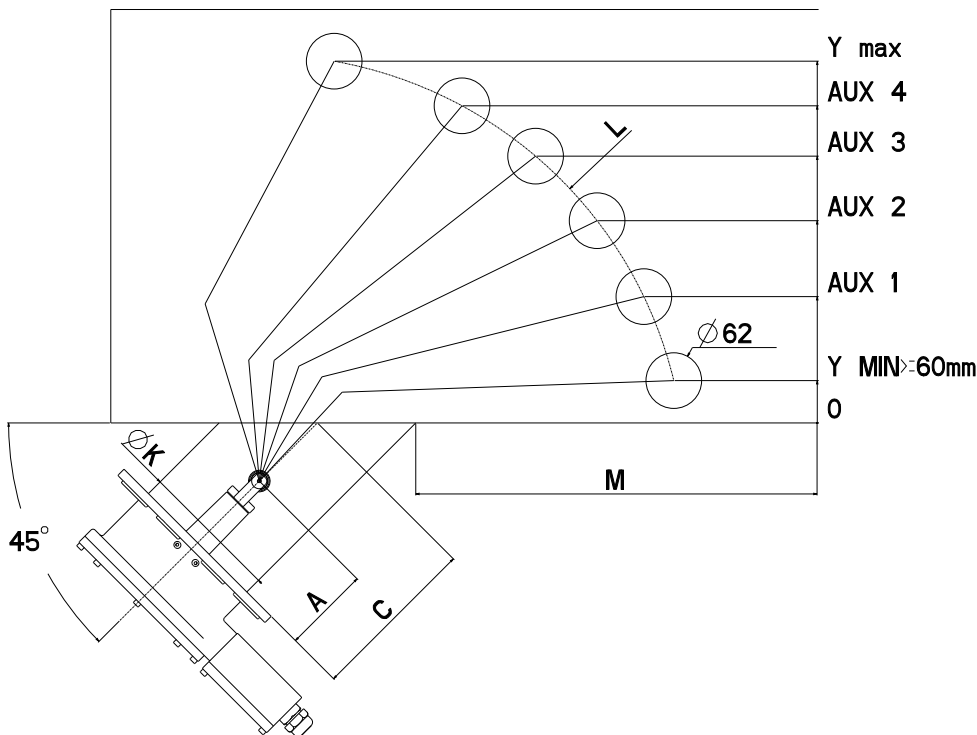

Bent arm lengths >=100mm

L	
---	--

For further information or clarification, please contact our support team. E-mail address: customerservice@it.comem.com

COMEM is an ISO 9001 system certified. Information subject to change without notice

Liquid level indicator carter design with axial movement (Fig.4 - page 7)

Date	
Rev.	
Customer reference	

Arm movements (Note: The arm is not included in the product)

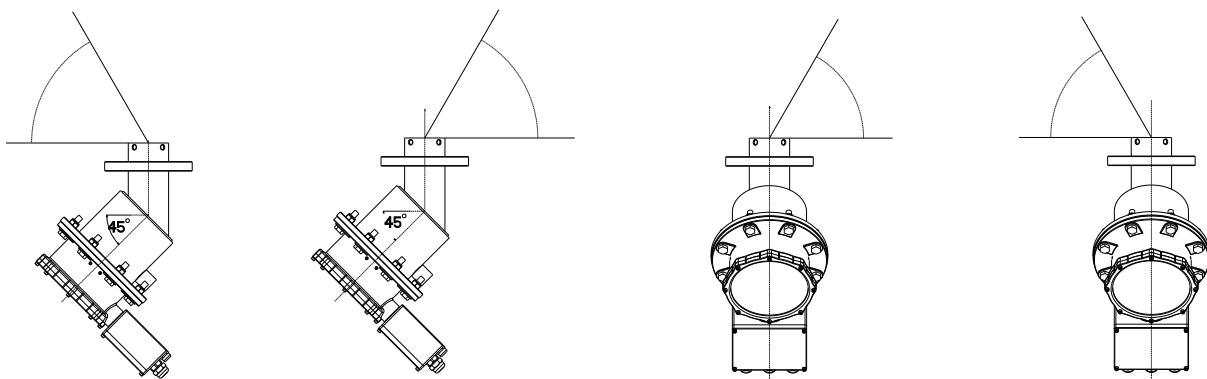
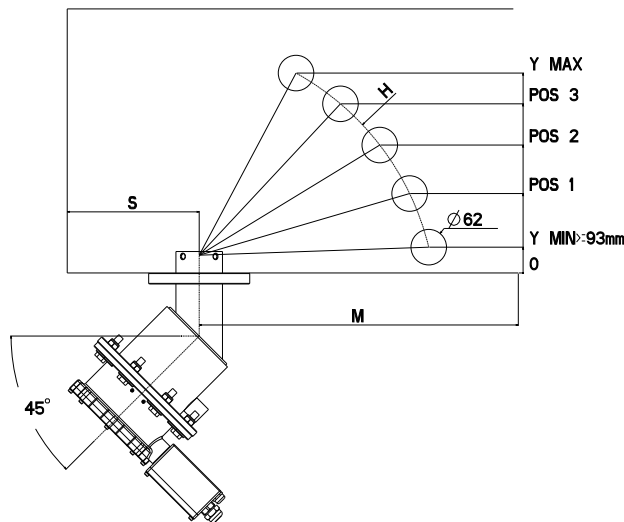
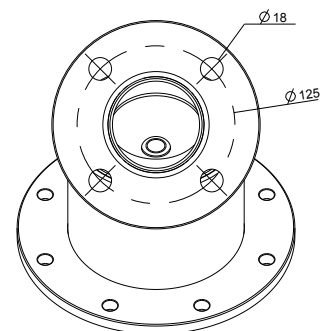

Fig. A <input type="checkbox"/>	Fig. B <input type="checkbox"/>	Fig. C <input type="checkbox"/>	Fig. D <input type="checkbox"/>
---------------------------------	---------------------------------	---------------------------------	---------------------------------



General features (mm)

Conservator diameter	Ø	
Conservator length	M	
Distance from the front of the conservator	S	



Note: Carter fixing flange included.

Liquid level indicator with angle design* with radial movement (Fig.5 - page 7)

Date	
Rev.	
Customer reference	

General features (mm)

Conservator diameter	Ø	
Conservator length	M	
Displacement between the conservator and dial centers	S	

Angle 1	Angle 2	Displacement F
-15° (C=64mm)	120°	18 mm
-30° (C=145 mm)	130°	44 mm
-45° (C=233mm)	140°	82 mm

*Angle design applicable for OLI, eOLI, OLI22, eOLI22 - see page 4)

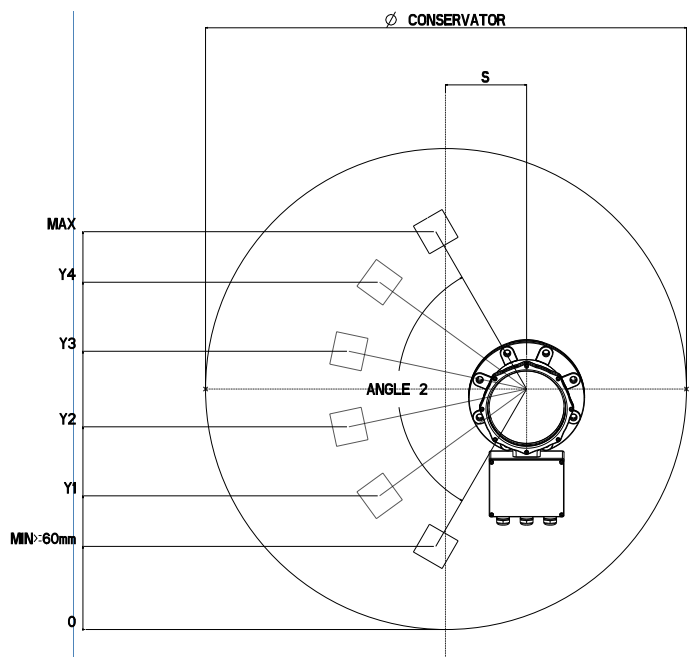
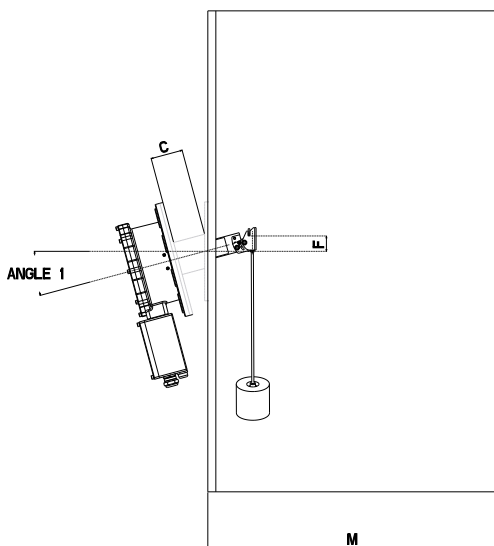

Length of the arm with float

Type	R: Standard (mm)	R: Special >=100mm
L140	370	
L220	550	
OLI	550	
OLI22	550	
L340	710	

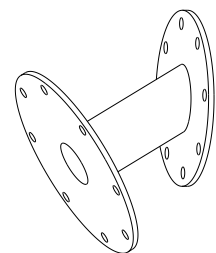
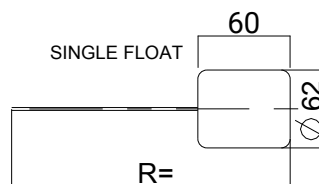

Note: Inclined fixing flange not provided.

COMEM SpA

Localita' Signolo 22, S.R. 11
36054 Montebello Vicentino
Vicenza - Italy
Tel +39 0444 449 311

www.comem.com

The data and illustrations are not binding. We reserve the right to modify the contents of this document without prior notice following the technical and product developments.

Copyright 2024 COMEM. All rights reserved

Technical guide-01-2024